

CASE STUDY



MIRAMAR COLLEGE

SAN DIEGO, CALIFORNIA

ARCHITECT	IBI GROUP BLUROCK PARTNERSHIP
FABRICATOR	CALIFORNIA PANEL SYSTEMS
INSTALLER	LA MESA GLASS
MARKET SEGMENT	EDUCATION
BUILD TYPE	NEW CONSTRUCTION
USE	FAÇADES
YEAR	2014

PRODUCT

TRESPA® METEON®
TRESPA® VIRTUON®
NATURALS, METALLICS



FINISH

SATIN

FIXING SYSTEM

TS110
VISIBLE (EXPOSED) FIXING
WITH SCREWS ON AN
ALUMINUM SUBFRAME



Think Trespa

TRESPA®

MIRAMAR COLLEGE

CREATING A CAMPUS COMMUNITY

WHEN A PRIVATE SOUTHERN CALIFORNIA COLLEGE NEEDED TO EXPAND, IBI GROUP AND BLUROCK PARTNERSHIP TURNED TO TRESPA TO HELP CREATE STUNNING SPACES THAT ARE FUNCTIONAL AS WELL AS BEAUTIFUL. SEVERAL BUILDING PROJECTS CAME TOGETHER TO TELL THE UNIQUE STORY OF THE STUDENTS, FACULTY AND STAFF.

With over 13,000 students, Miramar College was in need of expansion. In late 2009, construction of the Classroom Building began with a vision of a cohesive design in and out. Trespa® Meteon® panels had the durability as an exterior cladding option, which was exactly what the project needed. After completion in October 2010, nearly 34,600 square feet of Trespa® Meteon® was accounted for.

The San Diego Community College District Newsletter recognized Miramar's use of Trespa® Meteon® as an example of how funding was being used and how the product is a beneficial feature to the new building. Miramar College also highlighted their own project as a recruiting tool for new students, speaking on the new building and the unique façade improving the look of the campus.

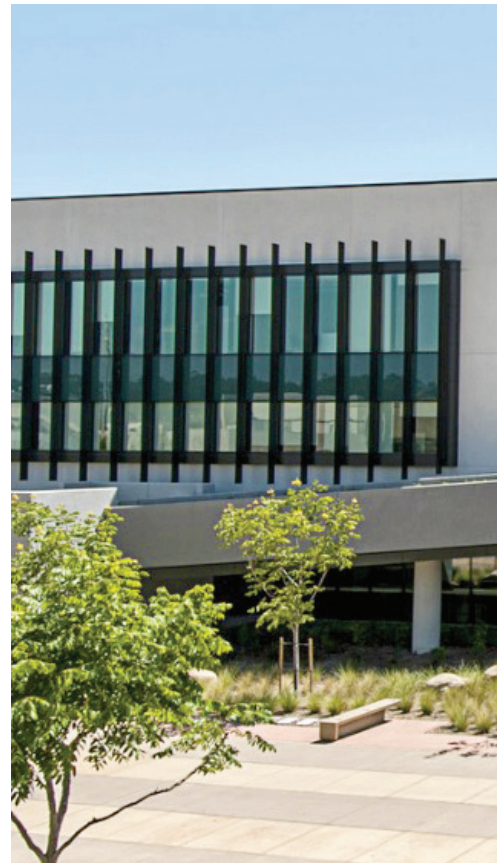

PROVEN RESULTS

Construction of the Student Union Building started early 2012 adding 23,000 square feet of Trespa® Meteon® to the campus. The vision behind this project was to create a building that had design aesthetics parallel to the Classroom Building, but with a unique feature to designate it as the central building on campus. The design intent behind the large curved walls of the Student Union was to mimic the bow of a ship.

The installation flexibility features and options for customization made Trespa® Meteon® panels the clear choice for exterior cladding on the building. The Urban Grey Metallics panels were also cut and scored to resemble the planks of a ship adding more unique detail to the campus.

Finally, the Administration Building façade was redone in 2014. After choosing Trespa® Meteon® for two other buildings on campus,

Think Trespa



“Trespa® Meteoron® panels were used on our campus buildings because they are low maintenance and are attractive; because we can draw multiple sizes along with a variety of colors, we have a lot of design freedom with the panels. The campus is happy with the look of the panels and, as opposed to other materials and products, I have not received any complaints from the maintenance staff.”

— Lance Lareau, District Architect, San Diego Community College District

the product demonstrated it’s outstanding performance and was the architect’s evident exterior cladding choice for the last project. Over 4,700 square feet of Trespa® Meteoron® was used on the exterior of the Administration Building continuing the cohesive design aesthetic throughout the new campus.

A PLACE TO GROW

Three buildings on the campus of Miramar College feature Trespa® Meteoron® panels. Using

the same panels on multiple buildings, added an interconnected, clean, modern look to the campus. Although the durability of the panels, low maintenance (easy to clean) and product guarantee were very appealing aspects in choosing to work with Trespa, the rainscreen protection, design flexibility and installation flexibility were also main factors when choosing Trespa® Meteoron® for the Miramar College projects. Another project using Trespa® Meteoron® at Miramar College is pending for 2015. ■



FIXING SYSTEM

TS110
VISIBLE (EXPOSED) FIXING
WITH SCREWS ON AN
ALUMINUM SUBFRAME

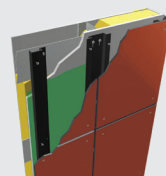

TRESPA®

CONTACT US

TRESPA NORTH AMERICA LTD.

62 Greene Street (Ground Floor)
New York, NY 10012
United States of America
Tel: +1 800 487-3772
Fax: +1 866 298 3499
Info.NorthAmerica@Trespa.com
www.trespa.com

VISIT US

TRESPA DESIGN CENTRE NEW YORK

62 Greene Street (Ground Floor)
New York, NY 10012
United States of America
Tel: +1 212 334 6888
Fax: +1 866 298 3499
TDC.NewYork@Trespa.com
www.trespa.com/us/tdc

FOLLOW US



DISCLAIMER

GENERAL

These terms apply to the use of this document and such use automatically means that the other party agrees to these terms. The information provided by Trespa International B.V. ("Trespa") in this document is solely indicative. Trespa is unable to warrant the accuracy and completeness of this information. Trespa may change the information included in this document at any time and without further notice. Trespa's customers and third parties must ascertain that they have the most recent document (for the most recent version, please consult: www.trespa.com). No rights can be derived from the information provided; the use of the information is at the other party's risk and responsibility. Trespa does not warrant that the information in this document is suitable for the purpose for which it is consulted by the other party. This document does not contain any design, structural calculation, estimate or other warranty or representation that customers and third parties may rely on. This document does not guarantee any properties of Trespa products. Colors used in Trespa's communications (including but not limited to printed matter) and in samples of Trespa's products may differ from the colors of the Trespa products to be supplied. Samples are not intended for use in product tests and are

not representative of characteristics of the Trespa products. Trespa's products and samples are produced within the specified color tolerances and the colors (of production batches) may differ, even if the same color is used. The viewing angle also influences the color perception. Metallics panels feature a surface whose color appears to change based on the direction from which it is viewed. The specified color stability and color specifications relate only to the decorative surface of the Trespa products, not to the core material and samples of the Trespa products. Trespa products are delivered ex-works with straight, sawn sides. Customers and third parties must have a professional adviser inform them about (the suitability of) the Trespa products for all desired applications and about applicable laws and regulations. Trespa does not warrant the above. The most recent version of the current delivery program and the Material Properties Datasheet can be found at www.trespa.info. Only the information in the most recent and valid Material Properties Datasheet should be used to select and provide advice regarding Trespa products. Trespa reserves the right to change (the specifications for) its products without prior notice.

LIABILITY

Trespa is not liable (neither contractual nor

non-contractual) for any damage arising from or related to the use of this document, except if and to the extent that such damage is the result of willful misconduct or gross negligence on the part of Trespa and/or its management. The limitation of liability applies to all parties affiliated with Trespa, including but not limited to its officers, directors, employees, affiliated enterprises, suppliers, distributors, agents, and representatives.

GENERAL CONDITIONS

All oral and written statements, offers, quotations, sales, supplies, deliveries and/or agreements and all related activities of Trespa are governed by the Trespa General Terms and Conditions of Sale (*Algemene verkoopvoorwaarden Trespa International B.V.*) filed with the Chamber of Commerce and Industry for Noord- en Midden-Limburg in Venlo (NL) on 11 April 2007 under number 24270677, which can be found on and downloaded from the Trespa website, www.trespa.com/documentation. All oral and written statements, offers, quotations, sales, supplies, deliveries and/or agreements and all related work of Trespa North America, Ltd. are governed by the Trespa North America General Terms and Conditions of Sale, which can be found on and downloaded from the Trespa website, www.trespa.com/documentation.

A copy of these general conditions of sale will be provided free of charge on request. All general terms and conditions other than the conditions mentioned above are dismissed and do not apply, regardless of whether such terms and conditions are referred to on requests for offers, offer confirmations, stationery and/or other documents of the other party, even if Trespa does not expressly object to such terms and conditions

INTELLECTUAL PROPERTY

All intellectual property rights and other rights regarding the content of this document (including logos, text and photographs) are owned by Trespa and/or its licensors. Any use of the content of this document, including distribution, reproduction, disclosure, storage in an automated data file or the dispatch of such a file without Trespa's prior written consent is explicitly prohibited. * Trespa, Meteon, Athlon, TopLab, TopLab^{PLUS}, TopLab^{ECO-FIBRE}, Virtuon, Izeon, Volkern, Trespa Essentials and Mystic Metallics are registered trademarks of Trespa.

QUESTIONS

Should you have any questions or comments, please do not hesitate to contact Trespa.